

MODEL UK USL 841

DROP IN OR UNDERMOUNT INSTALLATION

GENERAL

Fine quality sink bowl formed of 16 gauge
BA 304 18/10 nickel bearing stainless steel.
Includes installation hardware
Use for standart 36" cabinet

DESIGN FEATURES

Bowl Depth : 9"
Finish : Soft Satin Finish
Underside : Sound absorption technology
Drain Opening : 3-1/2"
Corner Radius : R10 mm (3/8")

OPTIONAL ACCESSORIES

Stainless Steel Bottom Grid
Wood Cutting Board
Glass Cutting Board
Stainless Steel Colander
Drying Rack



SINK DIMENSIONS (INCHES)

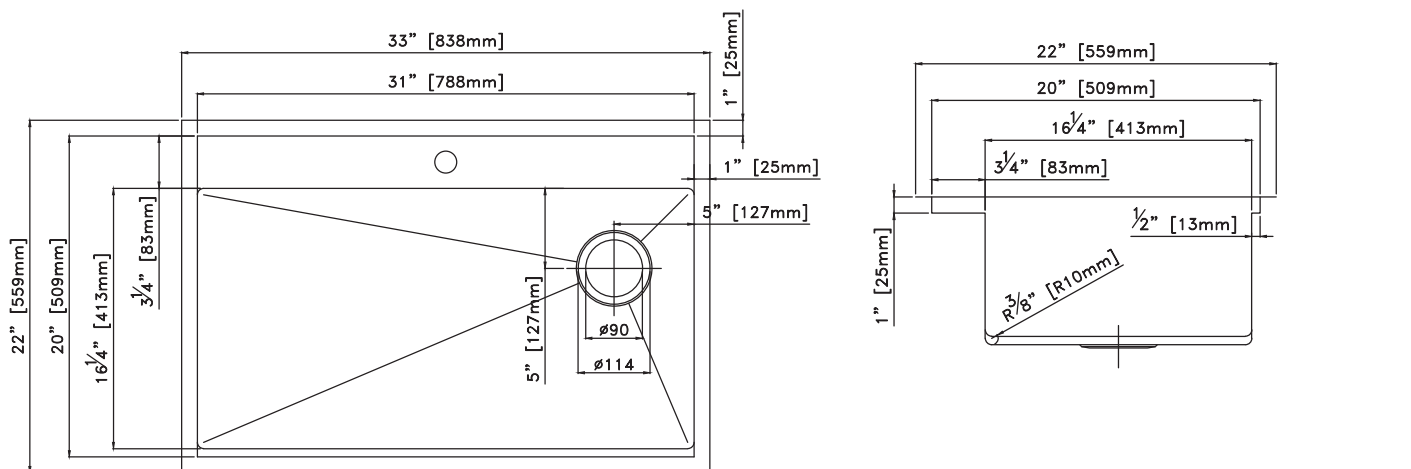

INSTALLATION PROFILE*

(Undermount)

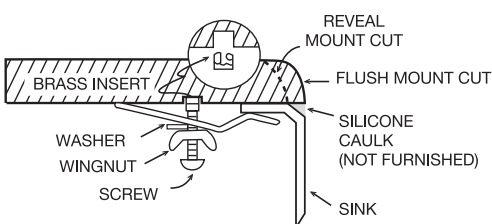

(Inset)

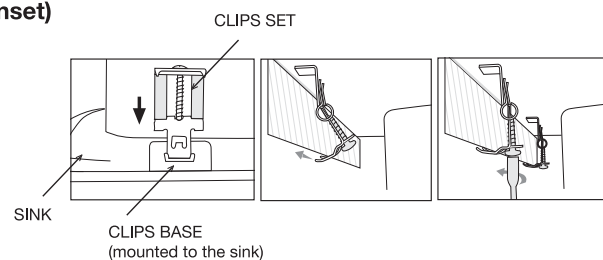

Ukinox reserves the right to change
product specifications without notice.
Printed in USA © 2023 Ukinox



*Template and countertop
mounting clips are packed
with every sink